

Installation instructions for the repair kit for MÖSCHA swiveling spreaders

For repairing MÖSCHA swiveling spreaders on your own, a repair kit, depicted to the right, is offered that consists of the following parts:

- 1 Tension spring [2]
- 1 Brass coupling sleeve [1]
- 2 Rubber bumpers [3]
- 3 Plastic sleeves [5]
- 1 Plastic washer, white [7a]
- 1 Plastic washer, black [7b]



A complete illustration of all spare parts and their assembly is shown by the exploded view drawing below. The spare parts are numbered and are referenced by [num].

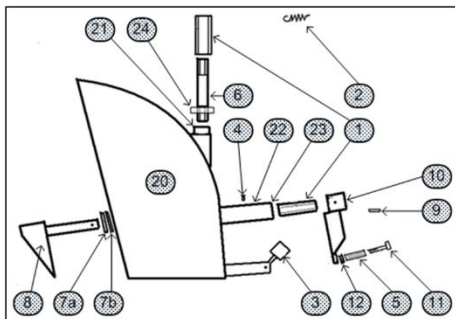

On the next page, the required procedure for repairing a MÖSCHA swiveling spreader is explained step by step.

Work steps for the repair with the spare parts of the repair kit:

1. Remove swiveling head [20] from spreader.
2. Unscrew grease nipple [4].
3. Drive out dowel pin [9].
4. Drive out deflection plate [8] with a drift punch.
5. Drive out brass coupling sleeve [1] from inside [22].
If the coupling sleeve is seated too tightly, a slot can be notched using a hacksaw. To do this, detach the saw blade on one side and slide it through the brass coupling sleeve. Then retighten the saw blade, saw out the slot and then drive out the coupling sleeve.
6. Insert the new brass coupling sleeve [1]; it should be possible to insert it at least 50% (about 40 mm) before a hammer is used; otherwise, grind it down conically from the outside.
7. Install grease nipple [4]; to do this, drill a hole through the brass coupling sleeve used with a 5 mm steel drill bit and cut M6 threads.
8. Slide washers [7a] and [7b] or two washers [7a] onto the shaft of the deflection plate [8] and install it.

Note 1:

The distance from the inner wall must be between 4.5 mm and 6.0 mm.

Note 2:

It must be possible to slightly move the deflection plate with the lever [10] installed.

Note 3:

If two washers [7a] are installed, it may be that the drilled hole for the dowel pin [9] and the lever [10] no longer fits. In this case, grind off up to 1 mm on the surface [23].

9. Install rubber bumper so that threads project 1 mm in the tightened state.
10. Completely reinstall swiveling head:

Note 1:

The swiveling head should turn symmetrically around the nozzle.

Note 2:

Nozzle and swiveling head must not touch each other. If necessary, grind off area [21] in order for the swiveling area to fit the nozzle.

Note 3:

The nozzle should extend approximately 1 mm into the swiveling head. Install washers as needed to accomplish this.

11. Attach and lubricate new tension springs [2].

Please get in touch with us if there are any questions or ambiguities.



MöSCHA GbR
Michael Gutter, Helmut Mößmer u. A.
Schalkshofen 3
D-89294 Oberroth
GERMANY

Phone 00 49 83 33 / 5 26
Fax 00 49 83 33 / 93 58 44
E-Mail info@moescha.de
Web www.moescha.de

